

INSTRUCTIONS FOR GAS SPRING ADJUSTMENT

(6200 CHAIR)

1. REFER TO OWNER MANUAL CHAIR TOP ASSEMBLY DRAWINGS FOR ITEM NUMBERS.
2. LOOSEN CAP SCREW IN BASE OF HEADREST AND REMOVE HEADREST.
3. LOOSEN (DO NOT REMOVE) THREE (3) SCREWS IN SIDE PLATE ASSEMBLIES – (ITEMS #9 AND #10)
4. REMOVE SIX (6) PHILLIP SCREWS AND FINISHING WASHERS IN BACK COVER.
5. REMOVE TWO (2) BOTTOM SCREWS IN HEADREST BRACKET (ITEM 15). (DO NOT LOOSEN TOP 2 SCREWS).
6. SLIDE BACK UPHOSTERY STRAIGHT UP UNTIL CLEAR, THEN LAY IT ON THE SEAT ---- SEE DRAWING 2 (ATTACHED).
7. LOCATE GAS SPRING (ITEM 57), AND LOCK NUT LOCATED AT TOP OF SPRING AND UP AGAINST PIVOT BLOCK (ITEM 2).
8. TURN THE LOCK NUT, MOVING THE NUT AWAY FROM THE PIVOT BLOCK (ITEM 2).
9. IF THE ADJUSTMENT IS BEING MADE BECAUSE THE CHAIR BACK DRIFTS WITH WEIGHT, TURN THE BLACK GAS SPRING (ITEM 57) WITH YOUR HAND, MOVING THE SPRING AWAY FROM THE PIVOT BLOCK (ITEM 2).
10. IF THE ADJUSTMENT IS BEING MADE BECAUSE THE CHAIR BACK WILL NOT RECLINE WHEN HANDLE IS ACTIVATED, TURN THE BLACK SPRING WITH YOUR HAND, MOVING THE SPRING TOWARD THE PIVOT BLOCK.
11. THE GAS SPRING IS PROPERLY ADJUSTED IF THE BACK CAN FULLY TRAVEL FROM UPRIGHT TO TABLE TO UPRIGHT WITH THE HANDLE PULLED DOWN OR RAISED, AND WILL NOT DRIFT BACK WHEN PRESSURE IS APPLIED TO BACK WITHOUT HANDLE BEING ACTIVATED.
12. ONCE ADJUSTMENT IS MADE TURN JAM NUT ON SPRING UNTILL TIGHTLY UP AGAINST THE PIVOT BLOCK (**FAILURE TO DO THIS WILL ALLOW THE CHAIR TO GO BACK OUT OF ADJUSTMENT**).
13. REASSEMBLE CHAIR.

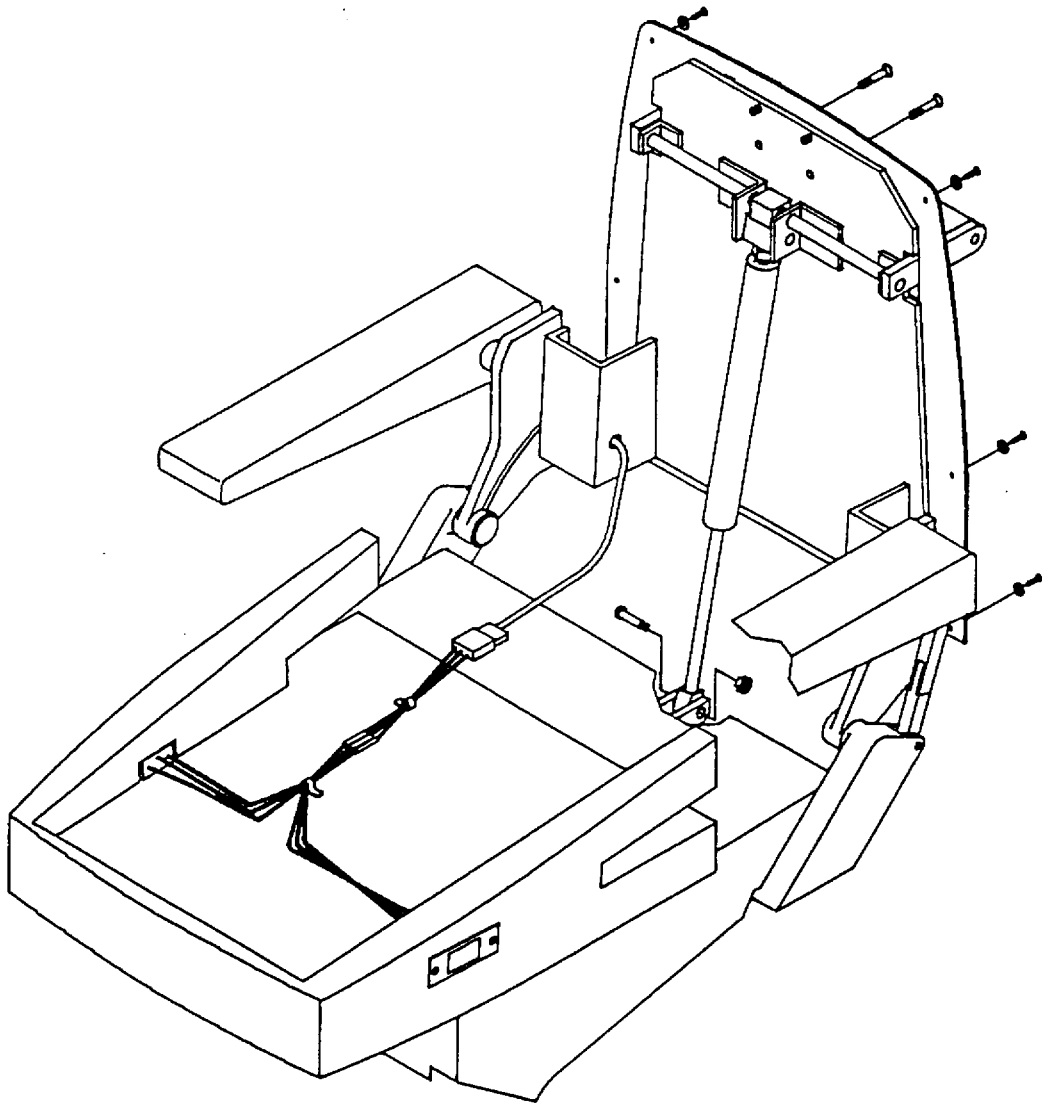

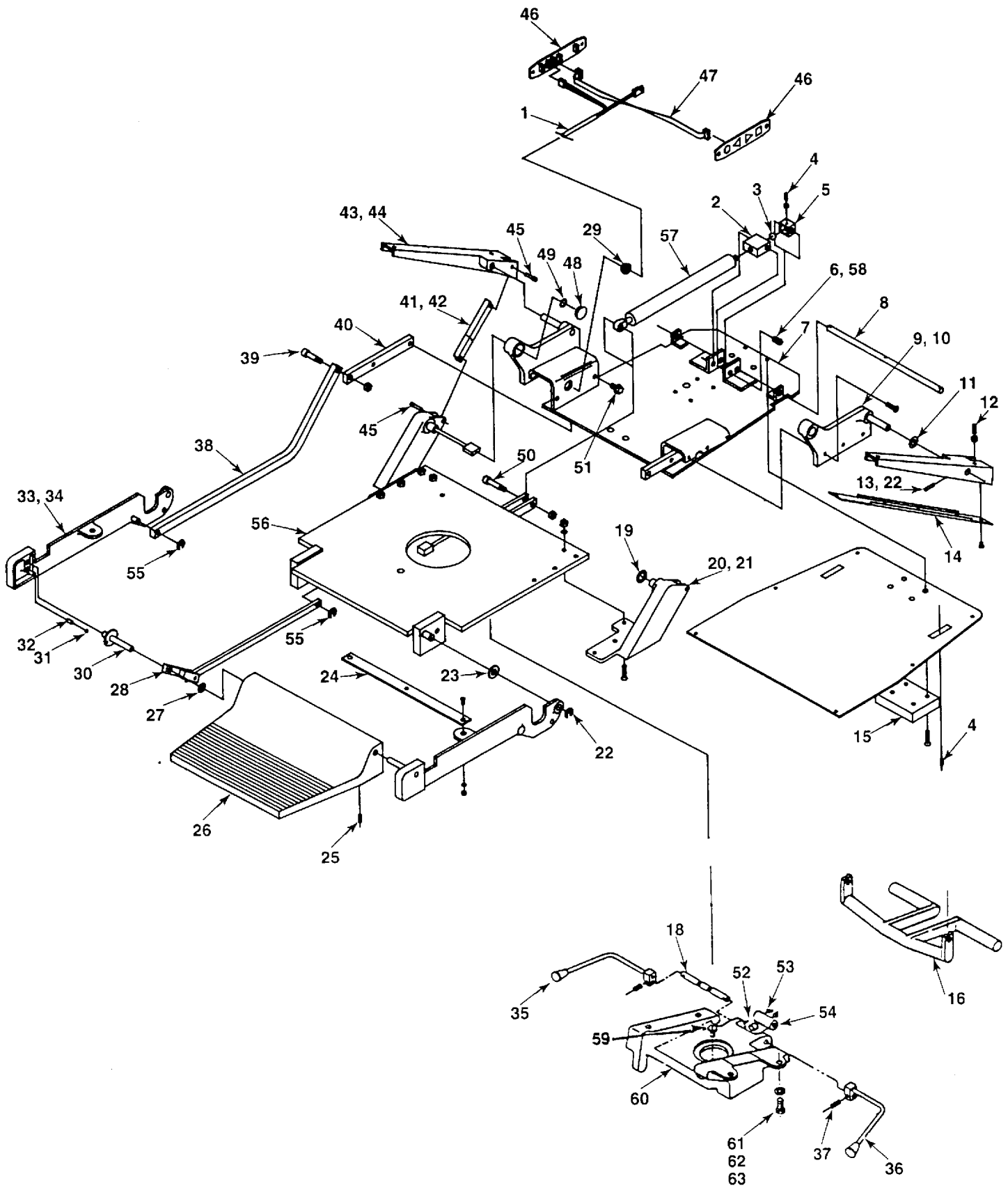

FIGURE 7. Chair Top Assembly

INSTRUCTIONS FOR GAS SPRING ADJUSTMENT
(6200 CHAIR)