

INSTRUCTIONS FOR GAS REPLACEMENT

(6200 CHAIR)

1. REFER TO OWNER MANUAL CHAIR TOP ASSEMBLY DRAWINGS FOR ITEM NUMBERS.
2. LOOSEN CAP SCREW IN BASE OF HEADREST AND REMOVE HEADREST.
3. LOOSEN (DO NOT REMOVE) THREE (3) SCREWS IN SIDE PLATE ASSEMBLIES – (ITEMS #9 AND #10)
4. REMOVE SIX (6) PHILLIP SCREWS AND FINISHING WASHERS IN BACK COVER.
5. REMOVE TWO (2) BOTTOM SCREWS IN HEADREST BRACKET (ITEM 15). (DO NOT LOOSEN TOP 2 SCREWS).
6. SLIDE BACK UPHOSTERY STRAIGHT UP UNTIL CLEAR, THEN LAY IT ON THE SEAT ---- SEE DRAWING 2 (ATTACHED).
7. LOCATE GAS SPRING (ITEM 57), AND LOCK NUT LOCATED AT TOP OF SPRING AND UP AGAINST PIVOT BLOCK (ITEM 2).
8. TURN THE LOCK NUT, MOVING THE NUT AWAY FROM THE PIVOT BLOCK (ITEM 2).
9. REMOVE SHOULDER BOLT (ITEM 50) THAT ATTACHES BASE OF GAS SPRING TO THE SEAT SUPPORT.
10. TURN THE BLACK GAS SPRING (ITEM 57) WITH YOUR HAND, MOVING THE SPRING AWAY FROM THE PIVOT BLOCK (ITEM 2) UNTILL THE SPRING IS REMOVED FROM THE BLOCK.
11. INSTALL THE NEW GAS SPRING INTO THE BLOCK AND ATTACH TO THE SEAT SUPPORT WITH THE SHOULDER SCREW.
12. THE GAS SPRING IS PROPERLY ADJUSTED IF THE BACK CAN FULLY TRAVEL FROM UPRIGHT TO TABLE TO UPRIGHT WITH THE HANDLE PULLED DOWN OR RAISED, AND WILL NOT DRIFT BACK WHEN PRESSURE IS APPLIED TO BACK WITHOUT HANDLE BEING ACTIVATED.
13. ONCE ADJUSTMENT IS MADE TURN JAM NUT ON SPRING UNTILL TIGHTLY UP AGAINST THE PIVOT BLOCK (**FAILURE TO DO THIS WILL ALLOW THE CHAIR TO GO BACK OUT OF ADJUSTMENT**).
14. REASSEMBLE CHAIR.

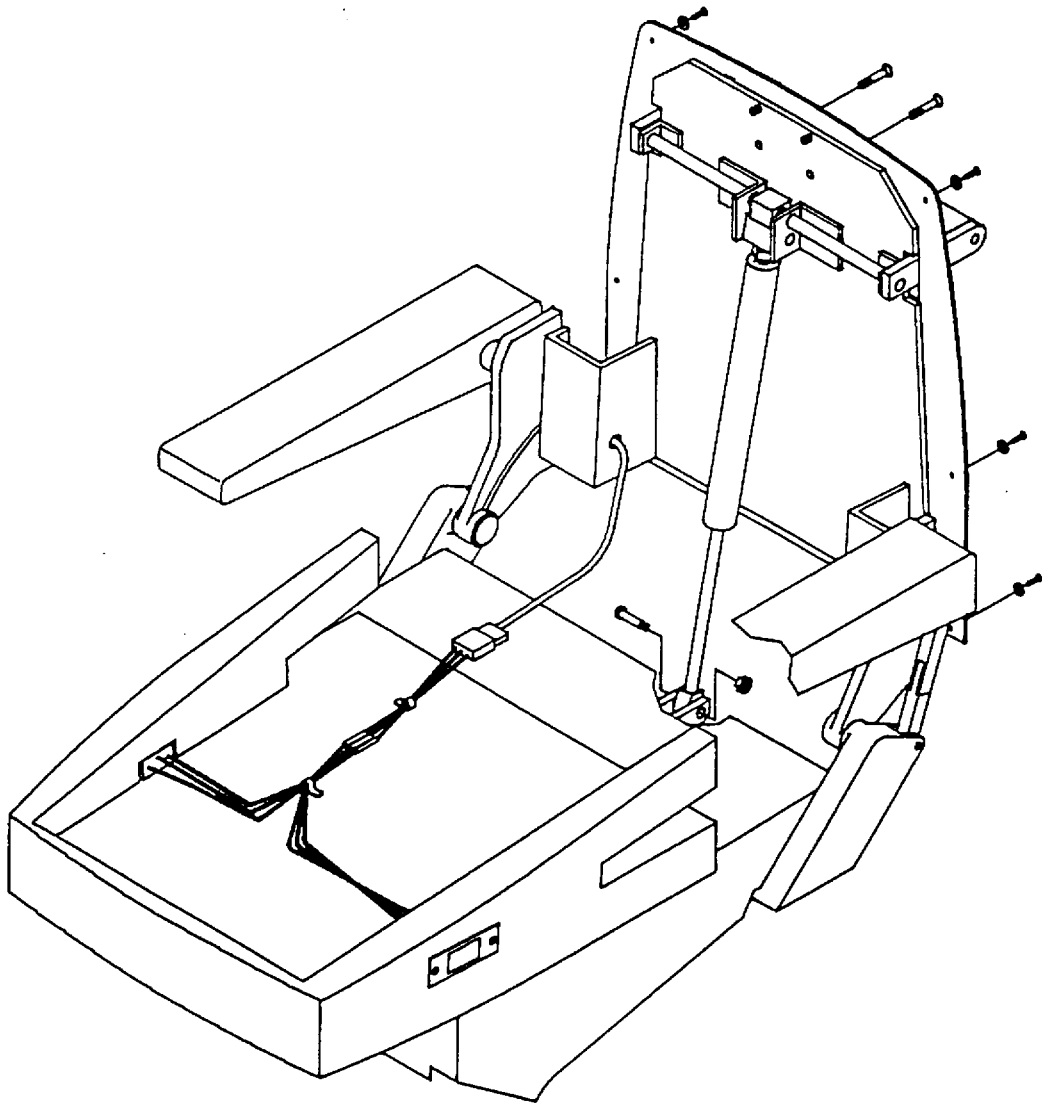

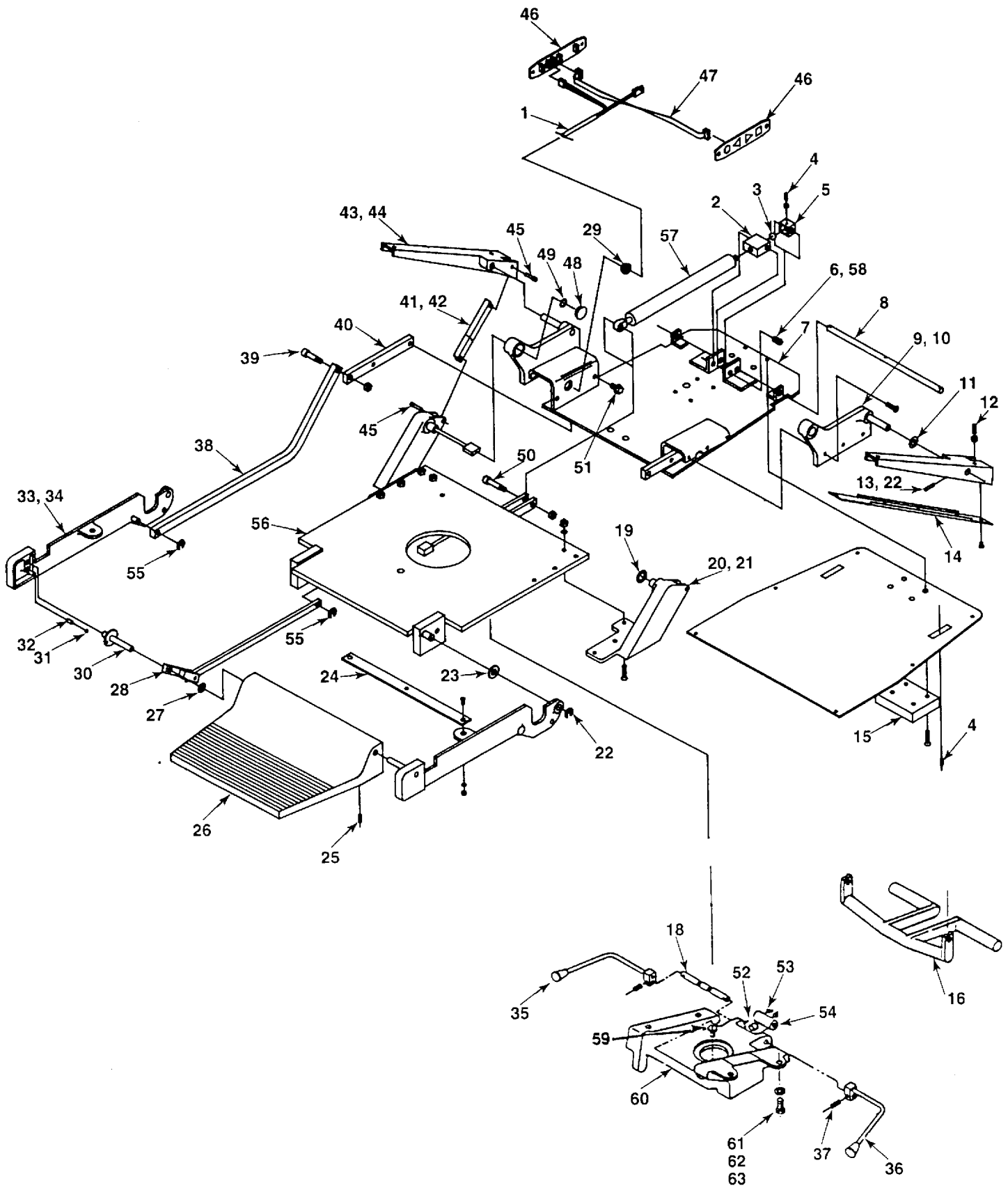

FIGURE 7. Chair Top Assembly

**INSTRUCTIONS FOR GAS REPLACEMENT
(6200 CHAIR)**